

JTS[®]

LIGHTER
SMALLER

MORE POWERFUL

UR-816PD / UT-16GTP

FC CE 1856     **RoHS**
compliant

59508-039-02

MINIATURE ***GUITAR***
WIRELESS SYSTEM

Instruction Manual

Thank you for choosing the JTS wireless system. In order to obtain the best efficiency from the system, you are recommended to read this instruction manual carefully.

INDEX

1. Important Caution	1
2. Features	1
3. Specification	2
3-1 Receiver // UR-816PD	2
3-2 Miniature Transmitter // UT16GTP	2
4. Part Identification & Accessories	3
4-1 Receiver // UR-816PD	3
4-2 Miniature Transmitter // UT16GTP	4
4-3 Accessories	4
5. Preparing Procedures & Basic Operation	5
5-1 Receiver	5
5-2 Battery Insertion Of The Transmitter	6
5-3 Install The Transmitter	7
6. System Operation	9
7. Recommendation	10
8. Important Notice	10

1. Important Caution

- Always make all connections before plugging the unit into an AC power outlet.
- Do not leave the devices in a place with high temperature or high humidity.
- Do not handle the power cord with wet hands!
- Keep the devices away from fire and heat sources.

2. Features

UT-16GTP provides true wireless experience to musicians. Within limited space it delivers uncompromised features.

- Innovative design for guitar player.
- UHF PLL 16 channels
- At least 60 meter operation distance
- Tone Key Squelch
- Higher signal to noise ratio
- One AAA 1.5V battery runs for 8 hours

3. Specification

3-1 Receiver// UR-816PD

Frequency Preparation.....	PLL Synthesized Control
Carrier Frequency Range.....	502~960 MHz
S/N Ratio.....	> 105dB
T.H.D.....	<0.6%@1KHz
Display.....	LED
Display Contents.....	Antenna A/B, RF /AF Status
Controls.....	Power On/Off, Channel Selecting, Audio Level
Audio Output Level.....	-12dB
AF Output Impedance.....	600Ω
Squelch.....	Pilot Tone, Noise and Mute
Operation Voltage.....	9-15 VDC, 200mA
Output Connector.....	1 Unbalanced Ø6.3mm phone jack
Dimension(m/m).....	124mm (W)* 33mm (H)* 73mm (D)

3-2 Miniature Transmitter // UT16GTP

Frequency Preparation.....	PLL Synthesized Control
Carrier Frequency Range.....	502~960 MHz
RF Outputs.....	Maximum 10mW
Stability.....	±10KHz
Frequency Deviation.....	±48KHz
LCD Display.....	Power On/Off, Low battery, Mute
Controls.....	Power On/Off, AF Level, Channel Selecting, Mute
Spurious Emissions.....	<-50 dBC
Audio Frequency Response	40~18,000 Hz
Battery.....	LR03, AAA 1.5V*1

4. Parts Identification & Accessories

4-1 Receiver// UR-816PD

Front panel

- ① Antenna
- ② Power switch and Volume control
- ③ LED display
- ④ Channel selector
- ⑤ ANT. A/B
- ⑥ AF indicator

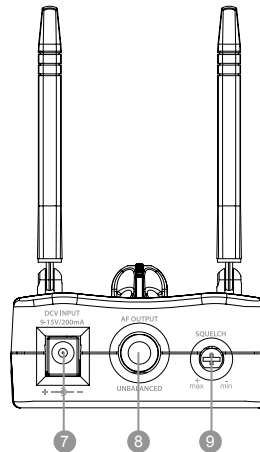
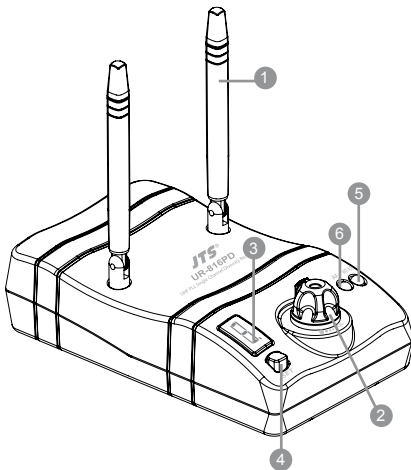

Rear panel

- ⑦ Power Supply Jack (9-15V/200mA): for connecting the power supply unit.
- ⑧ AF Output (6.3mm jack, unbalanced): for connection to a unbalance input. (Guitar Effect)
- ⑨ Tone-key squelch.

4-2 Miniature Transmitter // UT-16GTP

- ① UT-16GTP
- ② Power On/Mute/Off switch
- ③ LED indicator for power On/Off, battery status and mute
- ④ Channel selector
- ⑤ Input gain
- ⑥ Antenna
- ⑦ Ø6.3 Jack plug
- ⑧ Battery Lid (Color ID): Orange / White / Silver

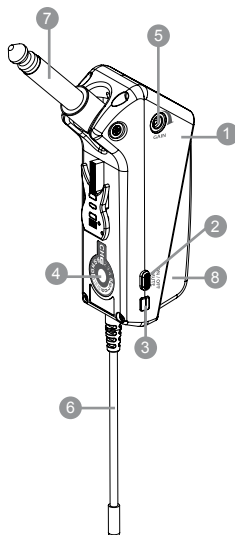

4-3 Accessories

- ⑨ AC/DC adaptor
 - A Switching Power Supply(100V~240V , 50~60Hz)
 - B Linear Power Supply (220V , 50Hz) Option
 - C Linear Power Supply (220V , 60Hz) Option
- ⑩ AF output cable (with Ø6.3 plug at both ends)
- ⑪ Screwdriver
- ⑫ Sucker Holder

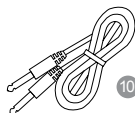
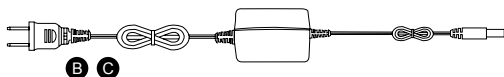
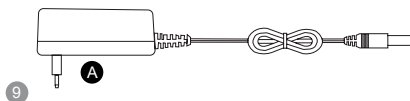

5. Preparing Procedures & Basic Operation

5-1 Receiver

- (1) Connect to the Guitar Effect.

Connect one end of cable to the AF Output socket, then plug another end to the input socket of Guitar Effects Pedals. (Step 1)

- (2) Connect the power supply unit

Plug in one end of AC/DC adaptor cable to Power Supply Jack in the rear panel of receiver, and plug another end into an AC outlet (Step 2)

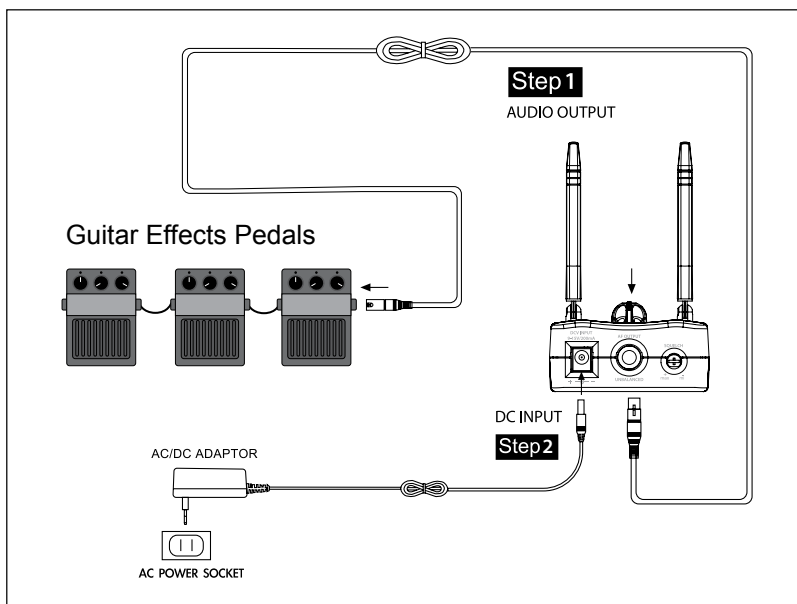

5-2 Battery Insertion Of The Transmitter

- (1) Press Down the battery lid ⑥ and slide it out.
- (2) Insert or replace with a new battery according to the polarity indication.
- (3) Switch the ON/MUTE/OFF ② switch to ON. If the battery is in good condition the LED indicator ③ will light in Green constantly. As soon as the battery goes below a preset level the LED indicator ③ will turn to Red constantly. Then the remaining battery life will last for 30 minutes only.
- (4) Slide and push back the battery lid.

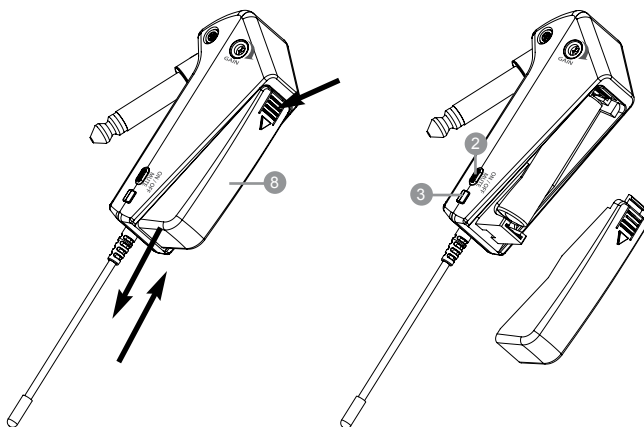

5-3 Install the transmitter

- (1) Use the UT-16GTP plug for guitar application
1. Plug the transmitter into the instrument to be used.
 2. Push down the transmitter towards the instrument. The step positioning mechanism will hold the transmitter firmly on the instrument.
 3. For traditional Gibson style end-mount input a sucker holder ¹² is provided to prevent swiveling of the transmitter.

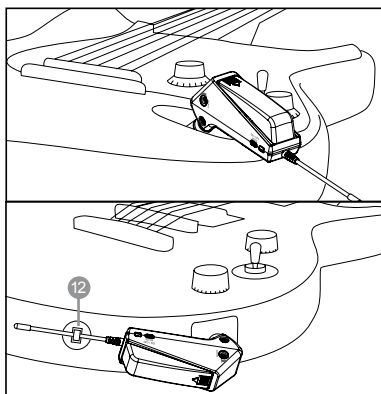
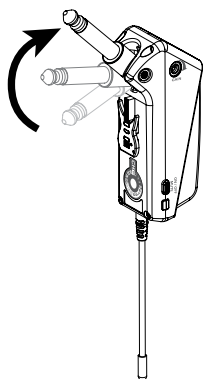

(2) Setting Levels

1. Set a common frequency for both the receiver and transmitter by turning the Channel Selector **4** with supplied screw driver.
2. Turn the input gain control **5** on the transmitter to a position halfway between the left and right stops.
3. Set the ON/MUTE/OFF switch **2** to ON to switch on transmitter.
4. Switch on the receiver and sound system.
5. Turn the volume control on the instrument to maximum level (clockwise) and play a few notes.
6. If the instrument sounds distorted turn down (count clockwise) the Input Gain **5** to a point where no distortion is heard. If the instrument sounds too low, turn up (clockwise) the Input Gain **5** just before distortion is heard.

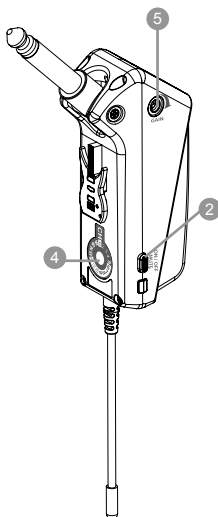

6. System Operation

Be sure to mute the audio signal of a mixer or amplifier before turning on the receiver and transmitter.

(1) Power on / OFF and Volume

Turn on or off the receiver and adjust the volume by rotating the volume control clockwise and reversely.

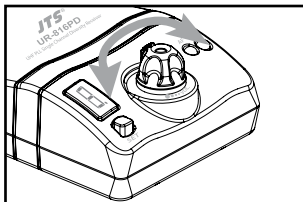

Always it is a good idea to keep “open space” between transmitter and receiver, that will improve RF reception.

(2) Selecting channel for the receiver and transmitter

Receiver

1. Hold “Channel Selector” ④ for about 3 seconds, the decimal point in LED Display starts flashing, allowing you to change the channel. Then, cycling press “Channel Selector” to select a desired channel from preset 16 channels. (0-9,A-F)

Notice: The LED Display will stop flashing if no operation for about 6 seconds.

Transmitter

Use the supplied screwdriver to select a desired channel for the transmitters.

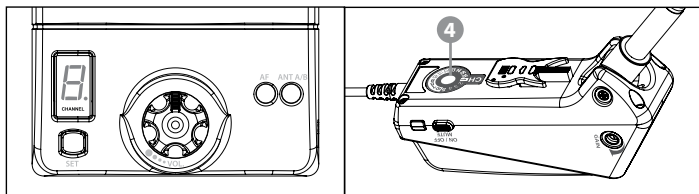

1. Both receiver and transmitters are preprogrammed with 16 channels.
2. Make sure the channel of receiver matches that of the transmitter.
3. When 2 or more transmitters and receivers are being used in the same location, they must be set up to use different channels. If existing channel is being interfered, please change to another non-interference channel.

7. Recommendation

- (1) In order to achieve the optimum reception condition and also extend the operating distance, please leave on “open space” between the receiver and transmitter.
- (2) Keep the devices away from the metal objects or any interference sources at least 50 cm.
- (3) Remove batteries from the battery compartment when the transmitter will not be used for a long time.

8. Important Notice

- (1) JTS offers wireless systems in a selection of bands that conform to the different government regulations of specific nations or geographic regions. These regulations help limit radio frequency (RF) interference among different wireless devices and prevent interference with local public communications channels, such as television and emergency broadcasts.
- (2) For information on bands available in your area, consult your local dealer or phone JTS. More information is also available at JTS's website (www.jts.com.tw).
- (3) This Radio apparatus may be capable of operating on some frequencies not authorized in your region. Please contact your national authority to obtain information on authorized frequencies and RF power levels for wireless microphone products.